

GKE/GBE

THE ECONOMICAL SOLUTION FOR FULL EFFICIENCY



GKE/GBE-Series

The GKE/GBE-Series are compact brazed plate heat exchangers designed for hydronics, perfectly suitable for applications with up to 30 bar/435 psi and max. 200°C/392°F. They offer an economical solution for decentralized hot water systems, separating systems and various regenerative applications.

With these high thermal efficient plate heat exchangers, you can handle everything with minimal size and weight for maximal efficiency, quality and profitability.

Applications for the GKE/GBE-Series:

- underfloor and conventional heating
- potable water heating
- hydraulic applications with low pressures

Always a suitable solution

The brazed plate heat exchangers from Kelvion offer tailor-made solutions for the widest range of applications. We configure the most economically favorable model for you from our wide range of available sizes and the numerous optional features. We adapt this with individually positioned connections to meet your specific requirements.

Your advantages at a glance:

- low investment costs
- high efficiency
- compact design
- ConBraz®-Design available
- modular design

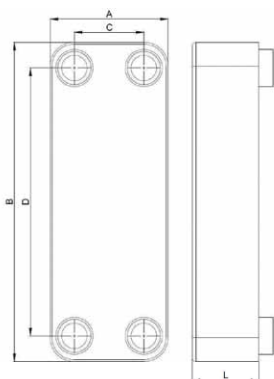

We need following information to select the optimum heat exchanger

- required temperature range
- flow rates or required heat load
- maximal permitted pressure drop
- required working conditions

Type	(bar)	Standard dimensions (mm)				(mm)	(kg)	(Litre/Chanel)	
Plate heat exchanger	Pressure	A	B	C	D	L-Dimension N = number of plates	Mass N = number of plates	Volume	Max. number of plates
GBE									
GBE 100M	16/10	74	204	40	170	$L=7.0+2.23 \times N$	$W=0.20+0.050 \times N$	0.025	50
GBE 200H	16/10	90	231	43	182	$L=10.2+2.24 \times N$	$W=0.60+0.060 \times N$	0.030	50
GBE 220H	16/10	90	328	43	279	$L=10.2+2.22 \times N$	$W=0.50+0.080 \times N$	0.046	50
GBE 240H	16/10	91	464	43	415	$L=10.2+2.20 \times N$	$W=0.84+0.140 \times N$	0.070	50
GBE 400H	16/10	124	335	73	281	$L=9.7+2.24 \times N$	$W=0.55+0.130 \times N$	0.065	50
GBE 500H	25/20	124	532	73	478	$L=9.7+2.23 \times N$	$W=1.0+0.210 \times N$	0.100	100
GKE									
GKE 550M	30/25	124	532	73	478	$L=9.35+1.75 \times N$	$W=1.0+0.210 \times N$	0.070	150
GKE 550H	30/25	124	532	73	478	$L=9.35+1.75 \times N$	$W=1.0+0.210 \times N$	0.070	150

GKE/GBE-Series: Specifications

- plate material: Stainless steel AISI 316L / 1.4404
- brazing material: Copper

Features

- Full-Flow System™ (models GBE 100, 200, 220, 240, 400, 500)
- ConBraz® Design (models 550M, 550H)

Performance limits

- working temperature: -196°C to +200°C / -321°F to +392°F
- working pressure: up to 30 bar / 435 psi

Approval

- PED (CE)
- ASME VIII-1



The specifications contained in this brochure are intended only to serve the non-binding description of our products and services and are not subject to guarantee. Binding specifications, especially pertaining to performance data and suitability for specific operating purposes, are dependent upon the individual circumstances at the operation location and can, therefore, only be made in terms of precise requests.

Kelvion Brazed PHE GmbH
 Remsaer Straße 2a, 04603 Nobitz-Wilchwitz, Deutschland
 Tel. +49 34 47 55 39-0
 Fax +49 34 47 55 39-30
 sales.nobitz@kelvion.com
 www.kelvion.com

Kelvion PHE GmbH
 Karl-Schiller-Straße 1-3, 31157 Sarstedt, Deutschland
 Tel. +49 50 66 601-0
 Fax +49 50 66 601-134
 sarstedt@kelvion.com